

**PLAN NO 1985**  
 FOR THE  
 IMPROVEMENT  
 OF "F" STREET  
 BETWEEN  
 FORTY-FOURTH & FORTY-EIGHTH STREETS  
 IN THE  
 CITY OF SAN BERNARDINO  
 CALIFORNIA

NOVEMBER 1951      R. D. FORSYTHE  
 City Engineer

PLAN ADOPTED Jan 7, 1952

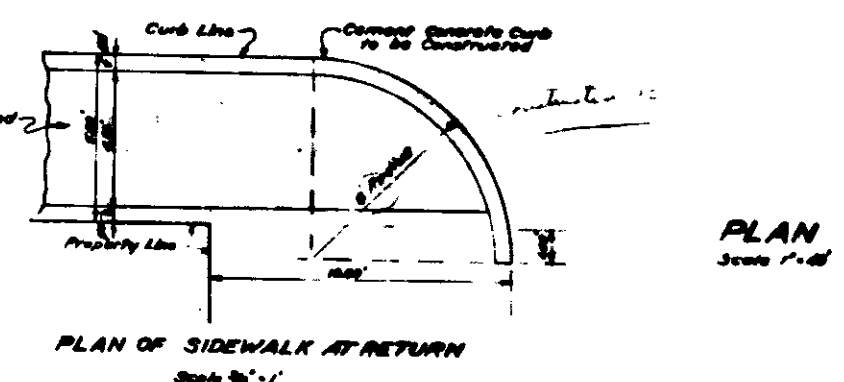
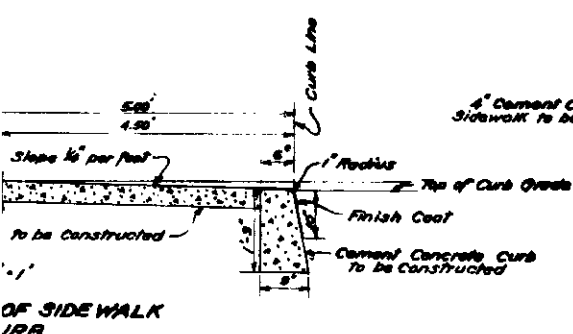

**PLAN**  
 Scale 1" = 40'

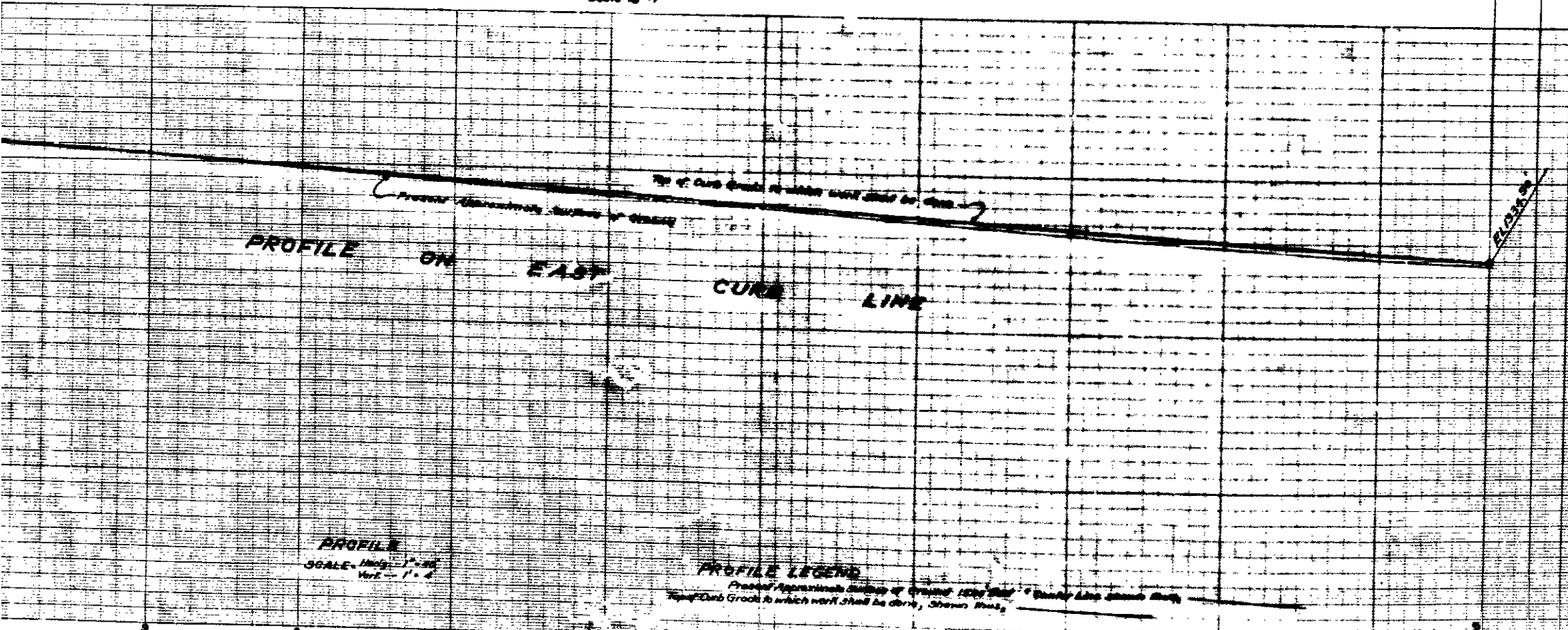

**LEGEND**

" or L means feet or less than  
 or R means feet or feet  
 N# means Number  
 C# means Center Line  
 E# means Elevation  
 Cement Concrete Curb to be Constructed  
 Cement Concrete Sidewalk to be Constructed

Shown on plan this  
 in Section this, 1951  
 Shown on plan this  
 in Section this, 1952

**TITLE TO STREET**

"F" STREET identified as FIRST AVENUE by Map No. APPROVED SUBDIVISION PLAT No. 2 recorded in Book 81 of Maps of Page 82 of San Bernardino County. Name of FIRST AVENUE changed to "F" STREET by Resolution No. 1688 of the City of San Bernardino.

**GRADE ORDINANCE**

Grade of "F" STREET was established by Resolution No. 2645 of the City of San Bernardino, California.

**DATUM**

All Elevations shown in this plan are to the datum of a plane which is 1645.88 feet below the City Bench Mark as established by Ordinance 303 of the City of San Bernardino, California.

**NOTE**

A 1/2" Expansion Joint shall be constructed at a distance of 30 feet from all Cement Concrete Curb & Sidewalk ordered Constructed on this plan.

**PROFILE**  
 SCALE: HORIZ. 1" = 40'  
 VERT. 1" = 4'

**PROFILE LEGEND**

Profile of Approximate Surface of Ground (CGP) shown  
 Top of Curb Grade to which work shall be done, shown thus,